

Clamp clip, triple, plastic pressure trough

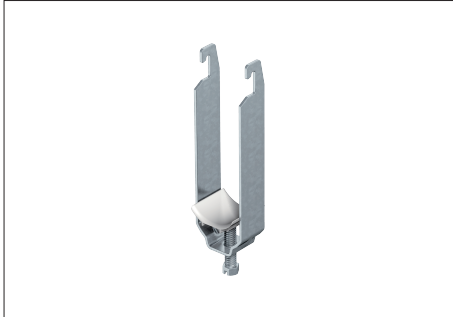

Suitable for all C profile rails with slot width 18 and 22 mm. Also suitable for flat, angle and U steel of 4 - 12 mm material thickness. BBS clamp and bolt made of hot-dip galvanised steel. Polypropylene pressure sleeve, halogen-free, colour light grey RAL 7035.

Type	Clamping range D mm	Pack. pcs	Weight kg/100 pcs.	Item No.
2056U 3 12 FT	8-12	50	4,750	1177 12 5
2056U 3 16 FT	12-16	50	4,850	1177 16 8
2056U 3 22 FT	16-22	50	6,600	1177 22 2
2056U 3 28 FT	22-28	50	10,500	1177 28 1
2056U 3 34 FT	28-34	50	13,250	1177 34 6
2056U 3 40 FT	34-40	50	14,400	1177 40 0
2056U 3 46 FT	40-46	50	18,950	1177 45 1

St Steel **FT** Hot-dip galvanised

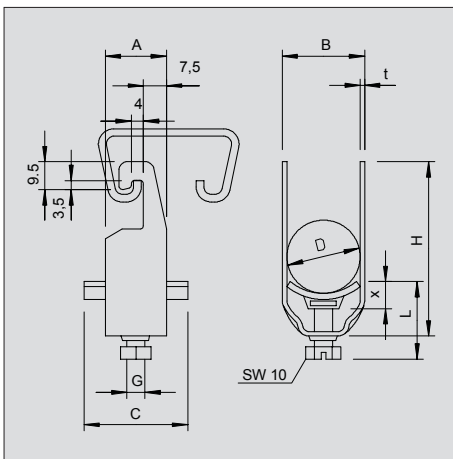

Important dimensions, clamp clip

EN	A	B	C	G	t	x	H	L
mm	mm	mm	mm	mm	mm	mm	mm	mm
8-12	20	16	34	M6	1,5	5	70	47
12-16	20	20	34	M6	1,5	5	82	47
16-22	20	27	34	M6	1,5	5	101	47
22-28	20	33	34	M6	2	5	119	47
28-34	20	39	34	M6	2	5,5	139	44,5
34-40	20	45	34	M8	2	5,5	157	44,5
40-46	20	51	40	M8	2	5,5	177	56,5